



[Kunnskapsbase](#) > [For administrators](#) > [Organisation Administrator](#) > [Implementation Guide](#) > [Integrations](#) > [Microsoft / Entra](#) > [How to add the Skolon Teams app to the menu bar](#)

## How to add the Skolon Teams app to the menu bar

Clara Hardarsson - 2026-01-12 - [Microsoft / Entra](#)

In this article, you will learn how to, as an administrator, add the Skolon Teams app to the Teams menu bar.

Select **Teams apps** in the menu on the left, then click on **Manage apps**.

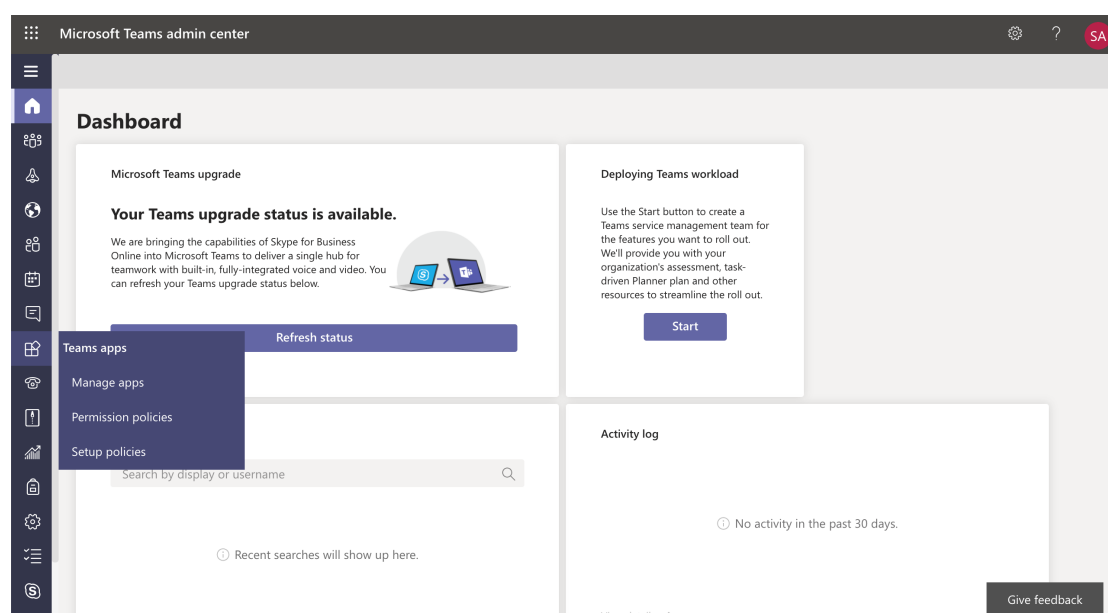

All available apps in Teams will be displayed. Here you can choose to allow or block apps in Microsoft Teams. Search for **Skolon**, after which you can assign the app.

Next, click on **Setup policies** and create a policy for which users at the current school should have the app.

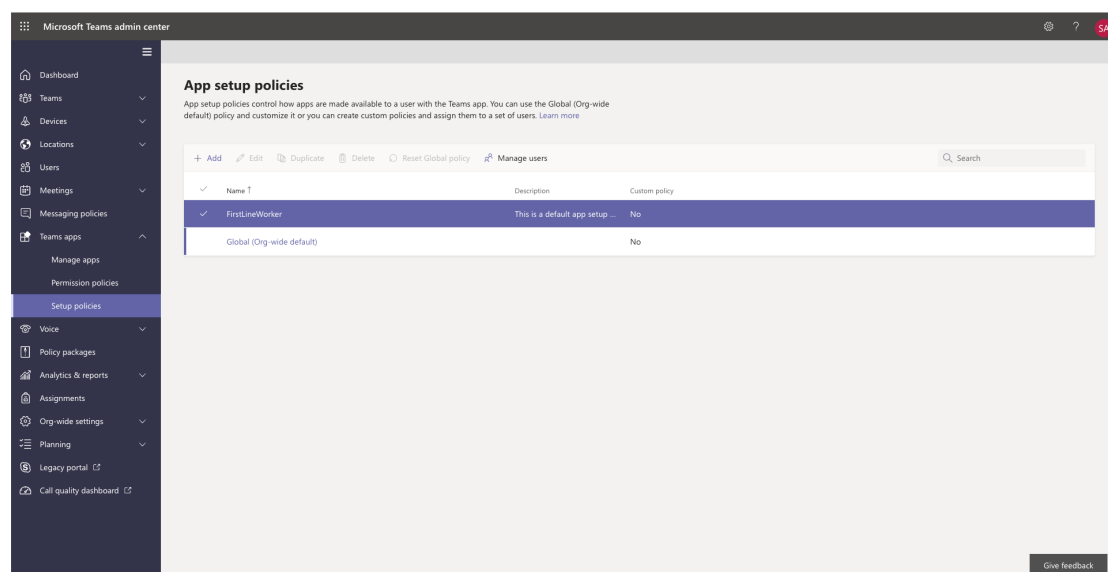

You select the group that should have access and click on **Add apps**.

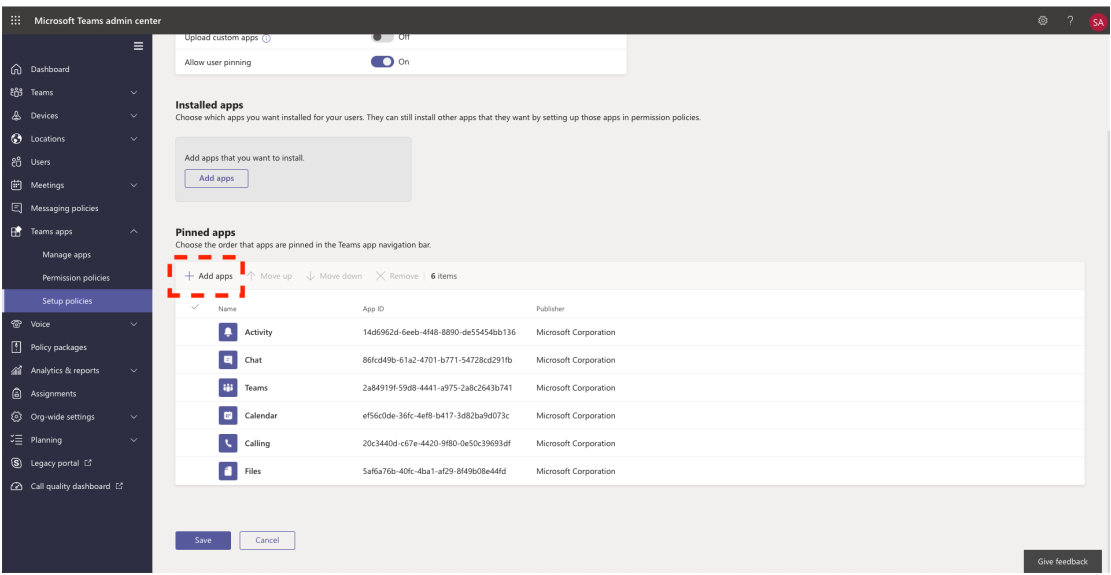

Policies are installed at the user level.

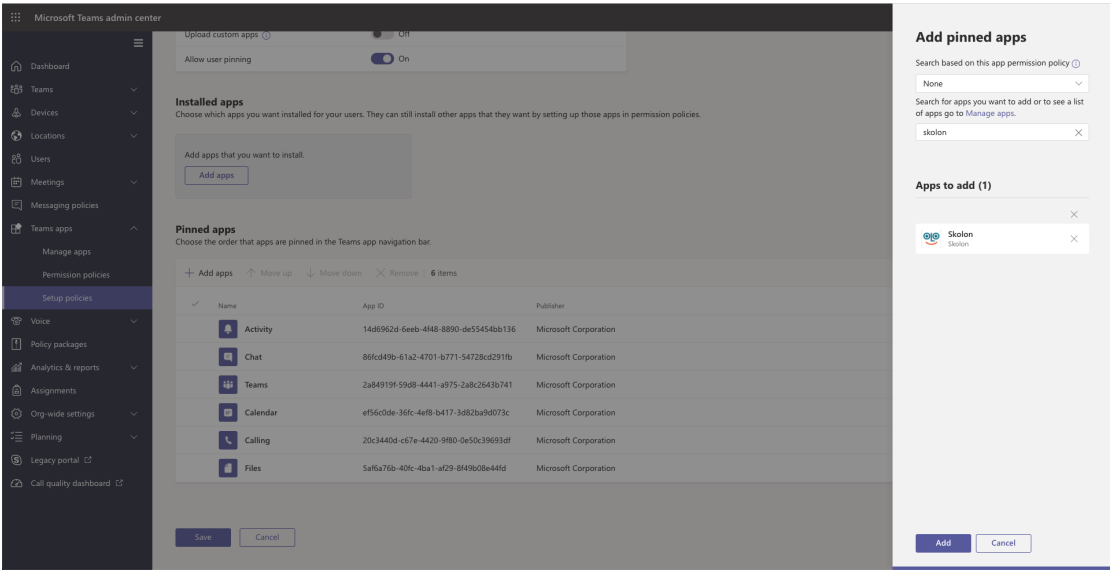

A script is required to install policies.

Microsoft Teams admin center

Dashboard

Teams

Devices

Locations

Users

Meetings

Messaging policies

Teams apps

Manage apps

Permission policies

Setup policies

Voice

Policy packages

Analytics & reports

Assignments

Org-wide settings

Planning

Legacy portal

Call quality dashboard

Users \ Adele Vance

Adele Vance

STUDENT

United States

Email

AdeleV@M365EDU099957.On

Microsoft.com

Directory status

-

7-DAY QUALITY

Data isn't available.

7-DAY ACTIVITY

0 Meetings

0 Calls

Account

Voice

Call history

Policies

Assigned policies

Meeting policy

Global (Org-wide default)

Messaging policy

Global (Org-wide default)

Live events policy

Global (Org-wide default)

App permission policy

Global (Org-wide default)

App setup policy

Global (Org-wide default)

Call park policy

Global (Org-wide default)

Calling policy

Global (Org-wide default)

Cancel ID policy

Policy package

Package assigned

None

Give feedback